

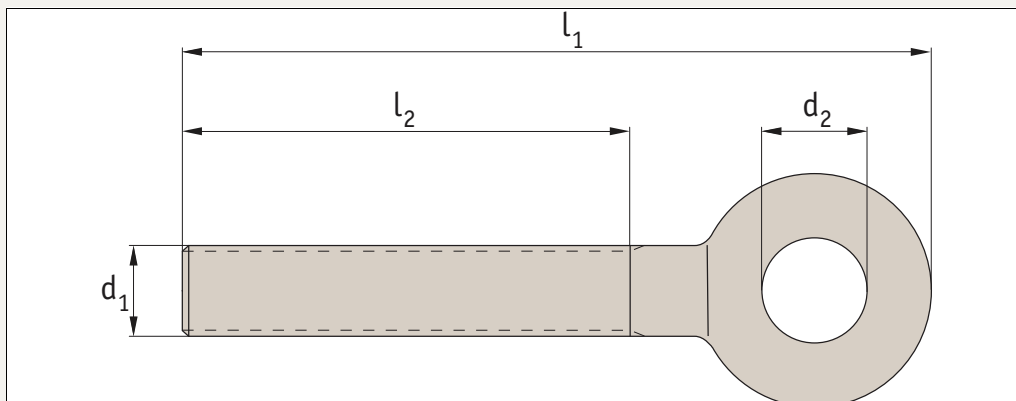

R3860



Material

Steel (1.0037).
Zinc plated (hot dip galvanized).

Important Notes

Turnbuckles are not to be used for lifting.
Only suitable for use in tension.

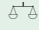
Order No.	Thread (hand)	d ₁	l ₁	l ₂	d ₂	 Kg
R3860.R006	Right	M 6	74	50	10	0,015
R3860.R008	Right	M 8	80	52	11	0,030
R3860.R010	Right	M10	95	59	15	0,050
R3860.R012	Right	M12	107	66	17	0,085
R3860.R014	Right	M14	158	85	18	0,130
R3860.R016	Right	M16	146	85	22	0,210
R3860.R020	Right	M20	170	100	24	0,380
R3860.R022	Right	M22	203	123	30	0,580
R3860.R024	Right	M24	213	134	33	0,830
R3860.R030	Right	M30	255	150	39	1,400
R3860.R036	Right	M36	260	150	37	2,180
R3860.R042	Right	M42	285	165	48	3,190
R3860.R048	Right	M48	335	185	58	4,970
R3860.L006	Left	M 6	74	50	10	0,015
R3860.L008	Left	M 8	80	52	11	0,030
R3860.L010	Left	M10	95	59	15	0,050
R3860.L012	Left	M12	107	66	17	0,085
R3860.L014	Left	M14	158	85	18	0,130
R3860.L016	Left	M16	146	85	22	0,210
R3860.L020	Left	M20	170	100	24	0,380
R3860.L022	Left	M22	203	123	30	0,580
R3860.L024	Left	M24	213	134	33	0,830
R3860.L030	Left	M30	255	150	39	1,400
R3860.L036	Left	M36	260	150	37	2,180
R3860.L042	Left	M42	285	165	48	3,190
R3860.L048	Left	M48	335	185	58	4,970